



Turnham Hall Turnham Lane

, Cliffe, YO8 6ED

Offers Over £1,000,000



Turnham Hall Turnham Lane

, Cliffe, YO8 6ED

Offers Over £1,000,000



Property Info:

Historical background: The manor house of Turnham Hall (historically known as Thurnam/Turneham Hall) forms the central hub of the old Turnham Estate in the village of Cliffe. The first building on the site was founded by Robert de Turnham during the reign of King Richard I, and was first documented in 1327, by which time it included its own chapel. By the mid-17th century it had become a fortified manor house, a Licence to Crenellate (or 'fortify') having originally been granted to a John Pylkington in 1477. The house was rebuilt several times over the centuries that followed, finally taking the form of the present Hall, built by William Burton circa 1800, and extended in 1820. It is said that traces of the old moat could still be detected until the 20th century. Rich with architectural detail, the house is of brick construction, partly rendered, with slate and pantile roofs and sash windows.

Parts of the site dating from 1680 onward fall within the 17th century Early Modern period, considered the beginning of the 'long 18th century' of Restoration/Georgian eras.

To Include:

The Foreman's House - Original servants accommodation - 3 bedrooms 1 bathroom property - ripe for further careful restoration.

The Coach House - Super storage, secure car parking or subject to planning further ancillary accommodation

Flood risk

This data comes from the Environment Agency

Flood risk: Very Low

Services: Septic tank, oil heating, mains water and electricity.

Council Tax Band:

Turnham Hall - Band G. North Yorkshire Council

No TPO'S that we are aware of - Tree Preservation Orders (on advice from the current owner)

Tel: 01757 709457



Road Map



Hybrid Map



Terrain Map



Floor Plan

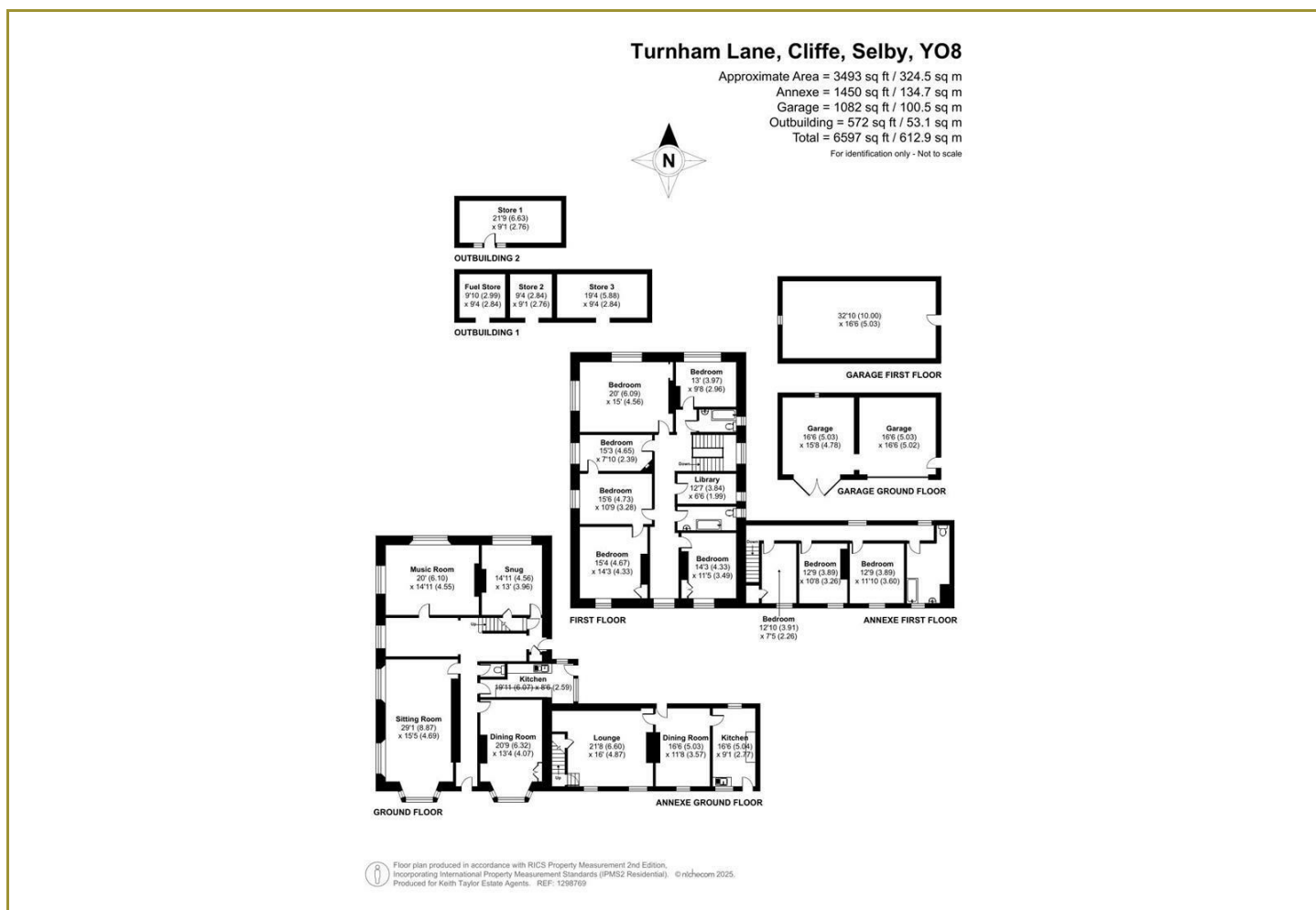

Viewing

Please contact our Selby Office on 01757 709457 if you wish to arrange a viewing appointment for this property or require further information.

Energy Efficiency Graph

These particulars, whilst believed to be accurate are set out as a general outline only for guidance and do not constitute any part of an offer or contract. Intending purchasers should not rely on them as statements of representation of fact, but must satisfy themselves by inspection or otherwise as to their accuracy. No person in this firm's employment has the authority to make or give any representation or warranty in respect of the property.

Keith Taylor

56 Gowthorpe, Selby, North Yorkshire, YO8 4ET
 Tel: 01757 709457 Email: sales@keithtaylorproperty.co.uk
www.keithtaylorproperties.co.uk